

FIRST FLOOR PLAN

Planning Permit No. A/1626/B/D/5

APPROVED

SUBJECT TO THE CONDITIONS IN THIS ORDER LETTER.

No. A2/18673/52 - 10/92

FOR MEMBER SECRETARY
MADRAS METROPOLITAN
DEVELOPMENT AUTHORITY
MADRAS - 600 009

22/10/92
22/10/92

Licensed surveyor
Srinivasan
S. SRINIVASAN, B.E. (CIVIL), M.E. (STRUCTURE)
Civil Engineer & Licensed Surveyor
Class 1 - No. 248
CORPORATION OF MADRAS
8-163, 7th AVENUE (UPSTAIRS)
BESANT NAGAR MADRAS 600 099

Job title * PP/M.C.No-157/90 dt 11.2.91
PROPOSED FLATS IN PLOT NO 5 OF APPROVED
LANO. 1/91 dt 25.3.91 IN RE SURVEY NO 641
OF VELACHERY-CORP OF MS 42 DIV 148 UNIT 30

Drawing Title
CORPORATION DRAWING
FIRST FLOOR PLAN

Drawn _____ Choked _____

Scale 1" = 4' 0"
Date 27-6-92

TYPE H4 3/3

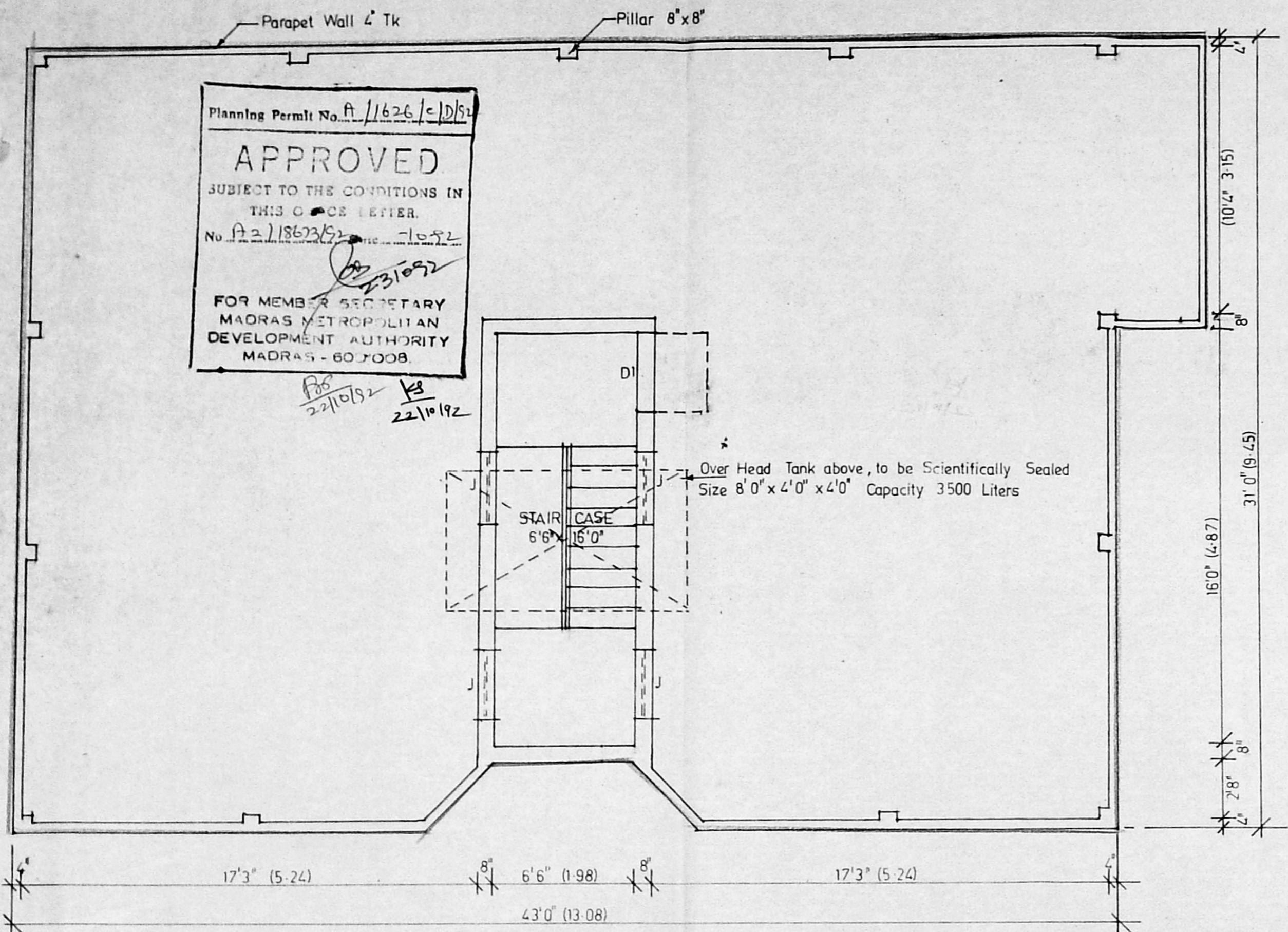

TERRACE FLOOR PLAN

OWNER'S SIGNATURE	
<i>S. Srinivasan</i>	
Licensed Surveyor	
<i>S. Srinivasan</i>	
S. SRINIVASAN RR (CIVIL) M.E. (STRUCT.) Civil Engineer & Licensed Surveyor Class I - No. 248 CORPORATION OF MADRAS No. 103, 7th AVENUE (UPSTAIRS) SESHANTH NAGAR, MADRAS 600 096	
Job Title	
* PP/M.C.No-157/90 dt 11-2-91 PROPOSED FLATS IN PLOT NO 5 OF APPROVED LA No 1/91 dt 25-3-91 IN RE SURVEY No 641 OF VELACHERY CORP OF MS. 42 DIV 148 UNIT 30	
Drawing Title	
CORPORATION DRAWING	
Drawn	Checked
Scale	Date
1" = 4'0"	29-1-92
TYPE - H 4	SH. 2/3

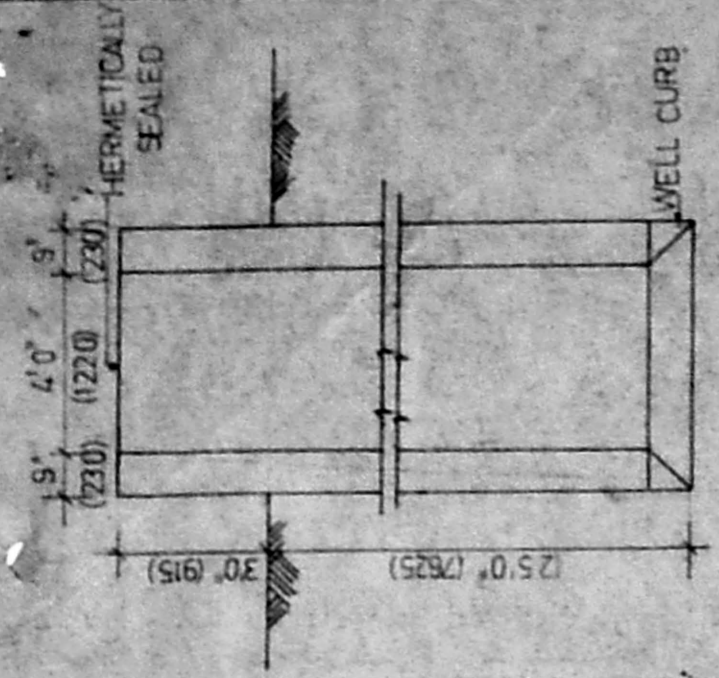

DETAILS OF WELL

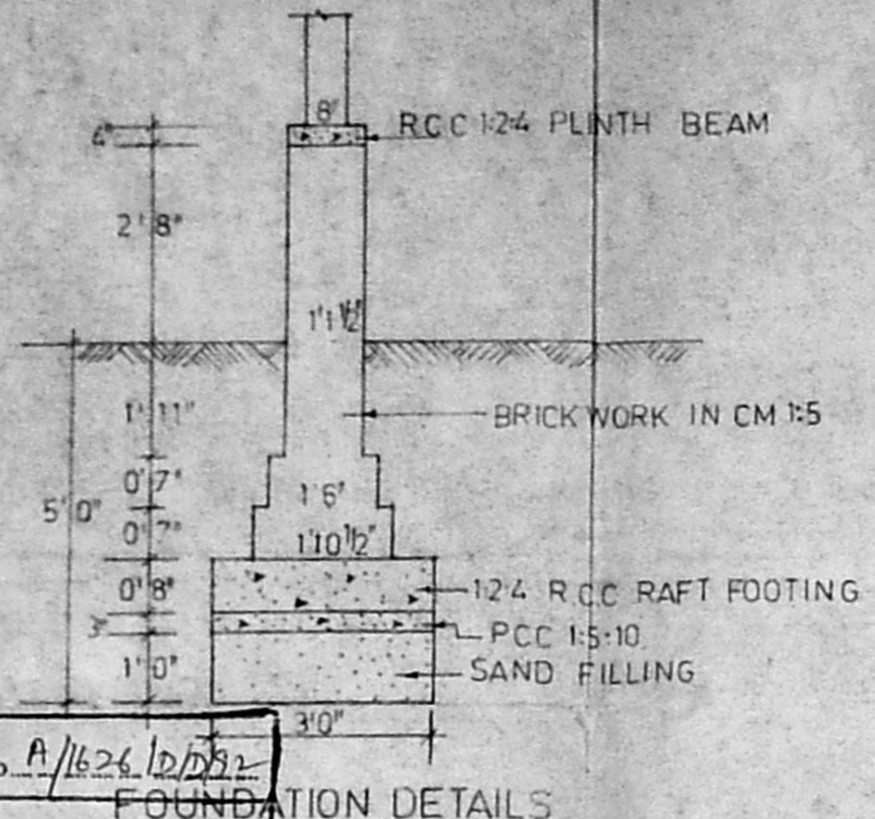

FOUNDATION DETAILS

Planning Permit No. A/1626/12/1992
APPROVED
 SUBJECT TO THE CONDITIONS IN THIS ORDER EITHER
 No. A2/18673/192
 FOR MEMBER SECRETARY
 MADRAS METROPOLITAN
 DEVELOPMENT AUTHORITY
 MADRAS 600 008

SECTION OF GRIT CHAMBER

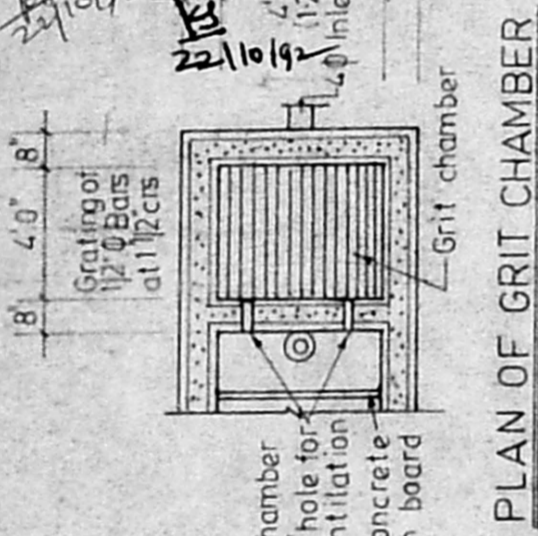

PLAN OF GRIT CHAMBER

LONGITUDINAL SECTION

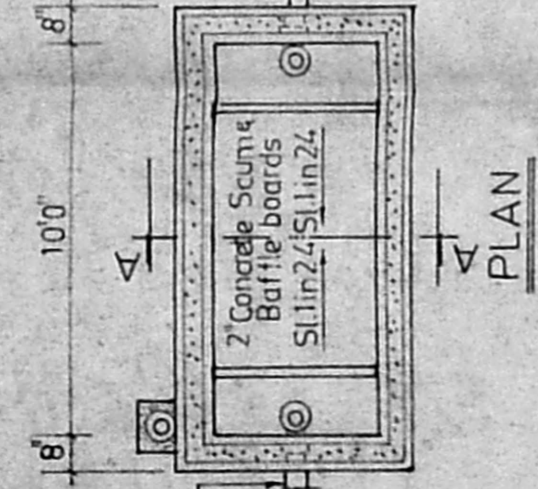

PLAN

DETAILS OF SEPTIC TANK

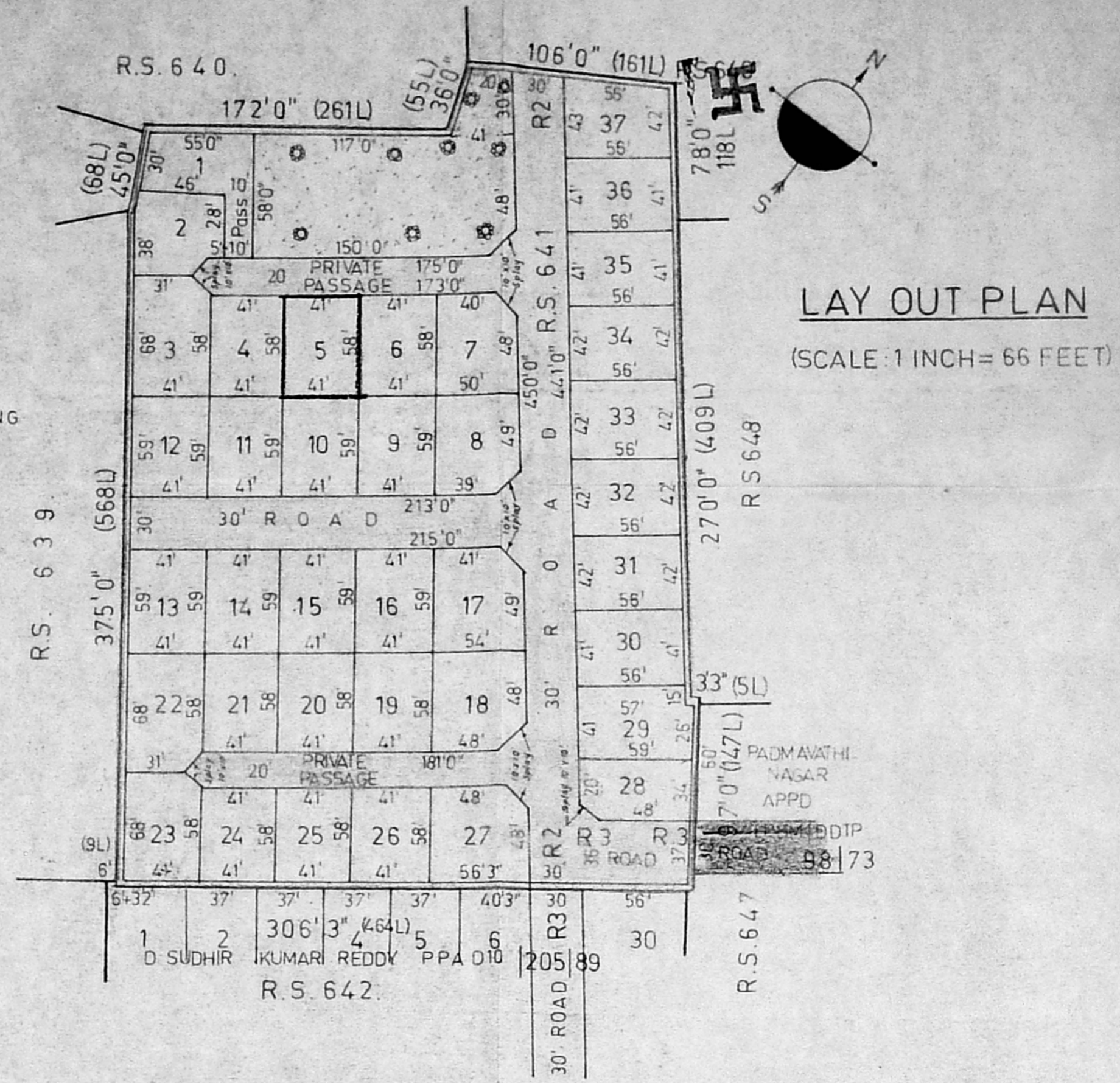

LAY OUT PLAN
 (SCALE: 1 INCH = 66 FEET)

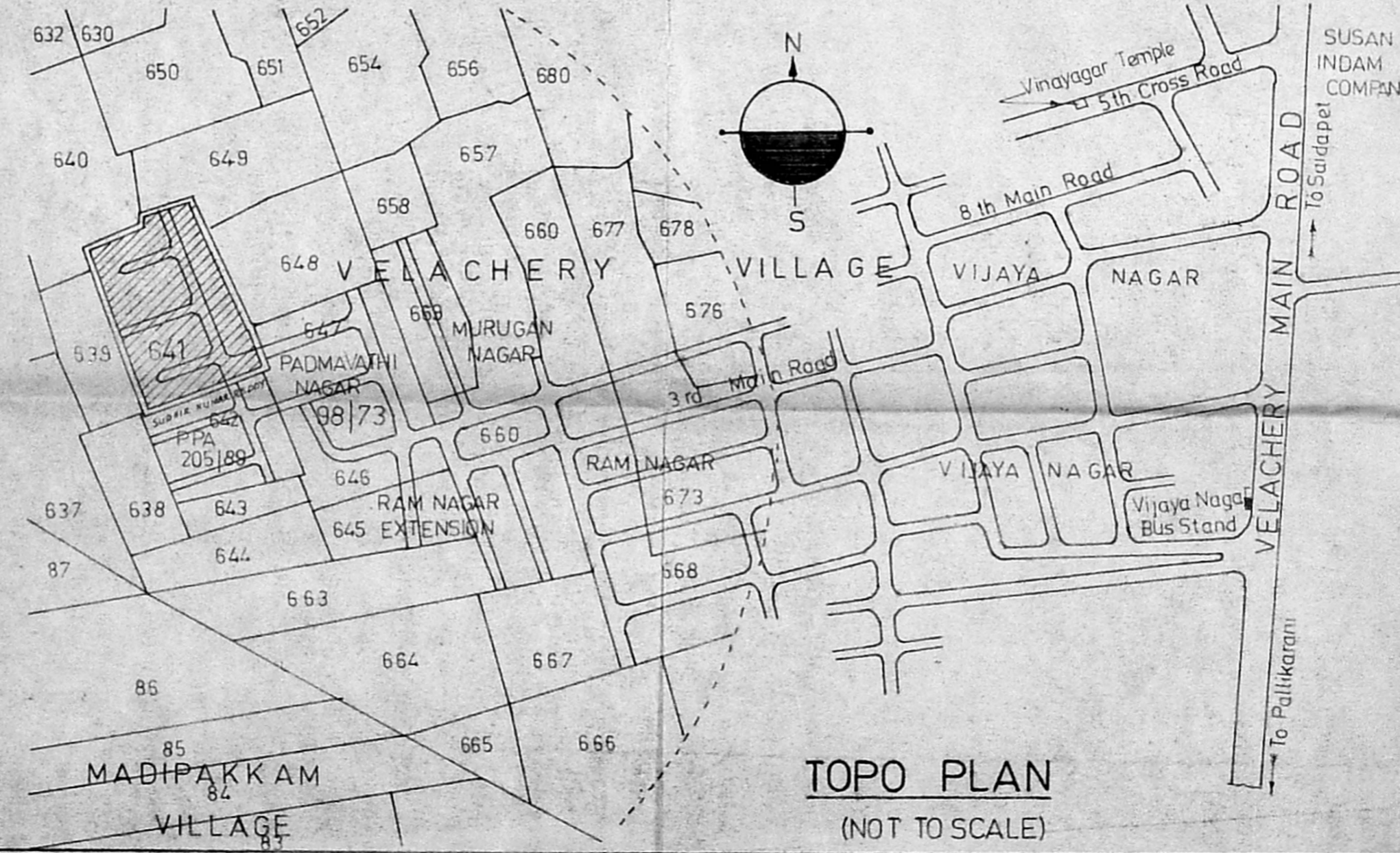

TOPO PLAN
 (NOT TO SCALE)

PLOT NO	EXTENT	
	SQ.FT	SQM
1	1945	180.70
2	1648	153.10
3	2738	254.36
4	2378	220.90
5	2378	220.90
6	2378	220.90
7	2850	264.77
8	2871	266.70
9	2419	224.70
10	2419	224.70
11	2419	224.70
12	2419	224.70
13	2419	224.70
14	2419	224.70
15	2419	224.70
16	2419	224.70
17	3048	283.16
18	3198	297.09
19	2378	220.90
20	2378	220.90
21	2378	220.90
22	2738	254.36
23	2738	254.36
24	2378	220.90
25	2378	220.90
26	2378	220.90
27	3263	303.12
28	1822	169.26
29	2356	218.87
30	2296	213.30
31	2352	218.50
32	2352	218.50
33	2352	218.50
34	2352	218.50
35	2296	213.30
36	2296	213.30
37	2380	221.10

Colour Indication

PLOT UNDER REF	[Shaded Box]
EXISTING ROADS	[Solid Line]
PROPOSED ROADS	[Dashed Line]
LAYOUT BOUNDARY	[Dotted Line]

Licensed Surveyor
S. SURESHAN, B.E. (CIVIL), M.E. (STRUCT)
 Civil Engineer & Licensed Surveyor
 Class I - No. 248
 CORPORATION OF MADRAS
 B-262, 7th AVENUE (UPSTAIRS)
 VEENAI NAGAR, MADRAS-600 099

Owner's Signature
[Signature]

Job Title
 PROPOSED FLATS IN PLOTS OF APPROVED LAYOUT (M M D A NO PPA D10/157/90)
 L A No D10/191 D19491 IN RE SURVEY No 641 OF VELACHERY - CORPOF MS 42 DIV 148 UNIT 30

Drawing Title
 CORPORATION DRAWING - LAY OUT PLAN

Drawn	Checked
Scale AS ABOVE	Date